

Tiger DR-RP Podiatry



Premium Gadox Flat Panel DR Solution



The Industry Leading DR Upgrade for Image Quality

Tiger DR-RP is the industry leading **GADOX** flat panel imaging solution for the podiatry market, which allows podiatrists a smart and cost-effective way to upgrade their current x-ray systems.

Tiger DR-RP comes with a single handle detector encasement that is designed for increased maneuverability and durability. Our specialized encasement has been designed to fit exclusively into our universal retrofit orthoposer, which allows for simple and easy integration with most x-ray models from leading manufacturers like X-Cel X-Ray, MinXray and Poskom. At only 3.5" tall, it's simple to position patients for every view.

TigerView is a podiatry-specific PACS software that understands the needs of the practitioner and has been developed with 30+ different podiatry measurements. Comprehensive AP and Lateral tool sets provide for quick and efficient patient diagnosis. Enjoy improved workflow with our user-friendly software.

Standard TigerView Retrofit packages include:

- ADA compliant ortho-base
- Ergonomic panel encasement
- 23" computer
- TigerView Podiatry PACS software
- Five viewing software licenses
- Bridges to EMR, EHS & PMS
- On-site install and training



LBS

4.5 lbs for 12x12, 6 lbs for 14x17



Panel available tethered or wireless



6 second image acquisition time



Directly integrates with TigerView software



No cassettes necessary



2 year x-ray Electrical
5 year x-ray Mechanical
4 year panel warranty

Call us for an in-office demo today
1-800-385-9593



Tiger DR-RP Podiatry

Premium Gadox Flat Panel DR Solution

SPECIFICATIONS

Sensor	
Sensor	a-Si TFT Array
Conversion Screen	Csl: TI / Premium Gadox
Image Data	16 bits
Limiting Resolution	3.5 lp/mm
12x12 Active Area	12x12 (287x287mm)
14x17 Active Area	14x17 (350x430mm)
12x12 Sensor Pixel	2048x2048
14x17 Sensor Pixel	2560x3072
Image Quality	
Data Transfer Time	Less than 1 second
12x12 Internal Storage	Up to 200
14x17 Internal Storage	Up to 150
Communication Interface	
Image Acquisition Time	3-5 sec. (approx)
Trigger Mode	AED (Auto Exposure Detection), Manual Trigger
Calibration Mode	ACC (Auto Calibration Control), Manual Calibration
Image Transmission	Gigabit Wi-Fi IEEE 802.11

Environmental	
Operating	
Temperature Range	10 - 35°C
Humidity Range (non-condensing)	20% - 75% RH
Storage	
Temperature Range	-10°C - 60°C
Humidity Range	10% - 90% RH
Water / Dust Proof	IP64
Mechanical	
12x12 Dimensions	308.5x319.5x15mm
14x17 Dimensions	385x460x15mm
12x12 Weight	4.4 lbs w/battery
14x17 Weight	6 lbs w/battery
Power	
Battery Performance	10 hours
AC Power	
Power Supply	100 - 240V AC
Frequency	50/60 Hz

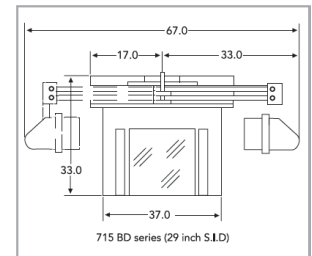

Call us for an in-office demo today
1-800-385-9593

2302 Beloit Avenue | Janesville, WI 53546 | 800.385.9593

www.televeresystems.com

TIGER-DR-RP-POD-01.14.22